



ARROW®

Maximal Barrier Precautions Tray

SAFETY FOR PATIENTS AND HEALTHCARE WORKERS

COMPREHENSIVE DESIGN

To help you deliver life-saving care and comply with the latest guidelines from the Centers for Disease Control (CDC), the Society for Healthcare Epidemiology of America/Infectious Diseases Society of America (SHEA/IDSA), Occupational Safety and Health Administration (OSHA) and the Institute for Healthcare Improvement (IHI), Teleflex Medical provides the Arrow Maximal Barrier Precautions Tray. It includes virtually everything you need to minimize the risk to your patient *and* yourself.

PROTECT YOUR PATIENT

Administering life-saving care means protecting your patient from further risk. To achieve that goal, the Maximal Barrier Precautions Tray comes complete with a comprehensive array of tools to help prevent central line infections, including:

Insertion checklist

The handy 21-step reference helps you comply with all relevant CDC and IHI guidelines.

Hi-Lite Orange® ChloraPrep® applicator

Makes it easy to follow the CDC 1A recommendation on preparing the insertion site with chlorhexidine.

Full body drape

Absorbent but impervious to fluids, the drape is carefully packaged for unfolding and fitting using sterile technique, and it covers the patient head-to-toe, per IHI guidelines.

ARROWgard® antimicrobial catheter technology

As per practice recommendations from the CDC, SHEA/IDSA, and others, ARROWgard's patented combination of silver sulfadiazine and chlorhexidine impregnated into the catheter surface saves lives and reduces costs by reducing infection—results that are supported by more than 30 studies.^{1,2} Hospitals can order the Maximal Barrier Precautions Tray with next-generation ARROWgard Blue PLUS® multi-lumen catheters, which feature silver sulfadiazine and chlorhexidine along the entire intraluminal path, plus increased levels of chlorhexidine on the catheter's external surface for even better protection.



Full body drape

ARROWgard antimicrobial catheter technology

Insertion checklist

Hi-Lite Orange ChloraPrep applicator

PRODUCT NO.	DESCRIPTION	NUMBER OF LUMENS
CDC-45703-P1A	7 Fr. x 20 cm ARROWgard Blue PLUS Pressure Injectible Central Venous Catheter	3

To purchase the Arrow Maximal Barrier Precautions Tray, call 800.523.8446 or visit www.arrowintl.com

Teleflex®
MEDICAL

Maximal Barrier Precautions Tray

SAFETY FOR PATIENTS AND HEALTHCARE WORKERS

PROTECT YOURSELF

The protective gear and upgraded sharps safety devices in the Maximal Barrier Precautions Tray not only protect your staff, they enable your hospital to classify its Venous Access insertion kits as “evaluated” and “implemented” per the Needlestick Safety and Prevention Act enforced by OSHA. Each kit’s user-safety equipment includes:

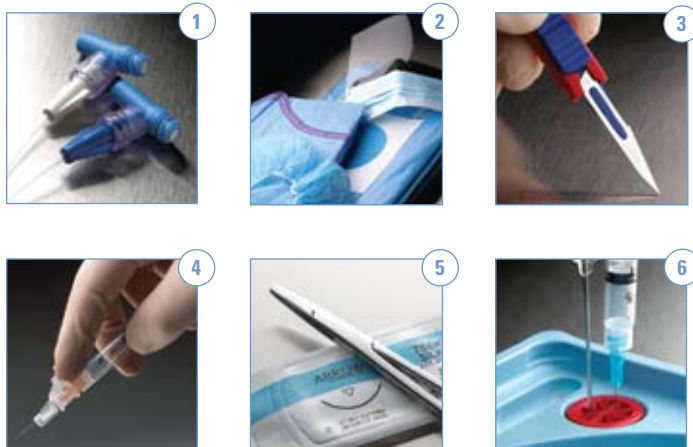

1 Positive Pressure Connector

Reduces risk of thrombotic occlusion by preventing reflux of blood when removing or changing devices at the needleless injection port

2 Mask with eye shield, surgical gown and cap

Impervious to contaminated liquids; comes folded for donning using sterile technique

3 Safety scalpel

Retractable blade for easy-to-control sharps protection

4 BD SafetyGlide® injection needles

Engineered to eliminate the tradeoffs between efficacy and safety

5 Suture set or STATLOCK® stabilization device

Curved suture needle and quality stainless steel needle holder or STATLOCK® stabilization device

6 SharpsAway II® Locking Disposal Cup

Easily and safely move used needles to disposal container

Product Platforms Available in Maximal Barrier Configurations:

- ▶ Central Venous Catheters (CVC)
- ▶ Peripherally Inserted Central Catheters (PICC)
- ▶ Midline Catheters
- ▶ Percutaneous Sheath Introducers (PSI)
- ▶ Multi-Lumen Access Catheters (MAC™)
- ▶ Acute Hemodialysis Catheters

REFERENCES:

¹ O’Grady NP, Alexander M, Dellinger EP, Gerberding JL, Heard SO, Maki DG, Masur H, McCormick RD, Mermel LA, Pearson ML, Raad II, Randolph A, Weinstein RA. Guidelines for the Prevention of Intravascular Catheter-Related Infections. *The Centers for Disease Control*. August 9, 2002; Vol 51, No RR10, pp 7-8.

² References include but are not limited to Maki 1997, Sampath 1995, and Bach 1994.

Full bibliography available upon request.

Arrow, ARROWgard, ARROWgard Blue, ARROWgard Blue PLUS, AGB⁺, and SharpsAway II are trademarks or registered trademarks of Teleflex Incorporated or its affiliates.

Hi-Lite Orange and ChloroPrep are registered trademarks of Cardinal Health Inc., or one of its subsidiaries.

SafetyGlide is a registered trademark of Becton, Dickinson and Company.

StatLock is a registered trademark of C.R. Bard, Inc. or an affiliate.

PATENTS:

ARROWgard/ARROWgard Blue PLUS: U.S. Patent Nos. 5,019,096, 6,706,024 and 6,812,195.
SharpsAway II: U.S. Patent Nos. 6,123,193 and 6,276,527.

Caution: U.S. federal law limits this device to sale by or on order of a physician. Contents of unopened, undamaged package are sterile. Disposable. Refer to package insert for current warnings, indications, contraindications, precautions and instructions for use.

For more information on reducing risk for patients and healthcare workers, visit us at www.FirstDoNoHarm.com

For additional reference information contact Teleflex Medical Incorporated. www.teleflexmedical.com

For ordering information or to locate a sales representative, contact Customer Service at:

United States	International
Tel: 800.523.8446	Tel: 1.610.655.8522
Fax: 800.343.2935	Fax: 1.610.655.8566

www.arrowintl.com

Teleflex
MEDICAL

Distribution Worldwide:

2917 Weck Drive, Durham, NC 27709 U.S.A. Tel: 919.544.8000

www.teleflexmedical.com

2008-0240 Rev 00 ABP-S

©2008 Teleflex Incorporated. All rights reserved. Printed in the U.S.A.